

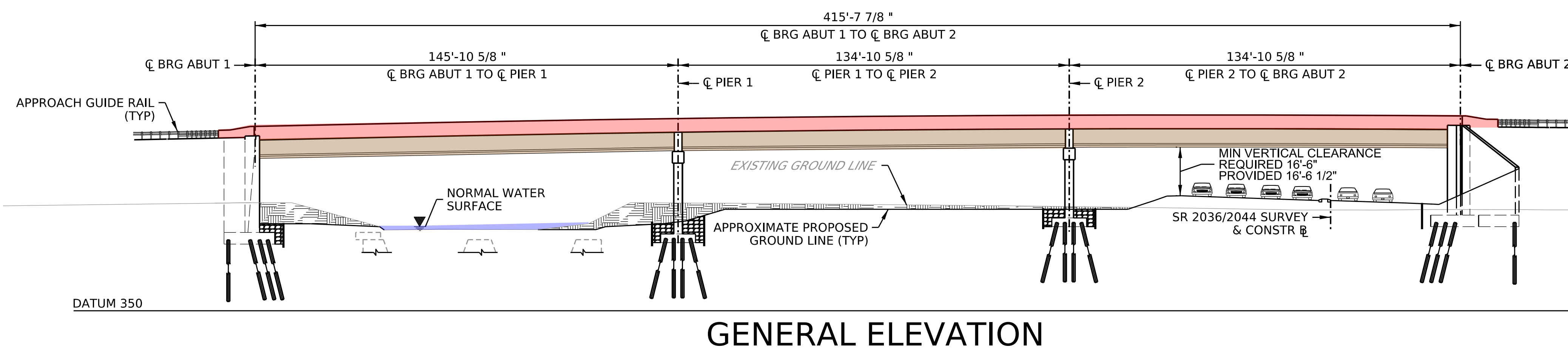

SR 309-19M MAINLINE STRUCTURE PLAN VIEW & ELEVATION

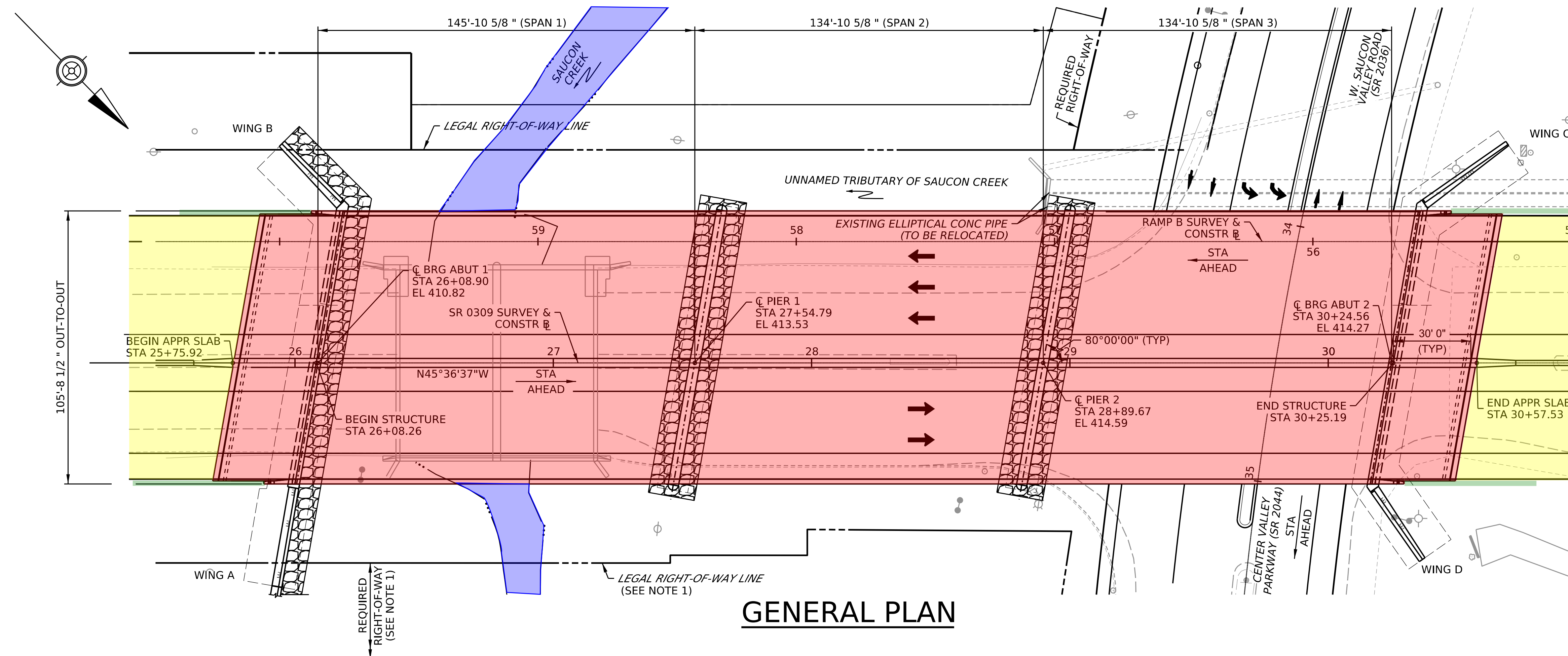

LEGEND:

- EXISTING GROUND TO BE REMOVED
- SAUCON CREEK
- PROPOSED RIP-RAP
- PROPOSED DECK & BARRIER
- PROPOSED GIRDERS
- PROPOSED GUIDERAIL
- PROPOSED ROADWAY

NOTES:

1. REQUIRED RIGHT-OF-WAY LIMITS ARE BEYOND EXTENTS OF THIS PLAN.



SR 309-19M MAINLINE STRUCTURE STAGING & TYPICAL SECTION



Michael Baker
INTERNATIONAL

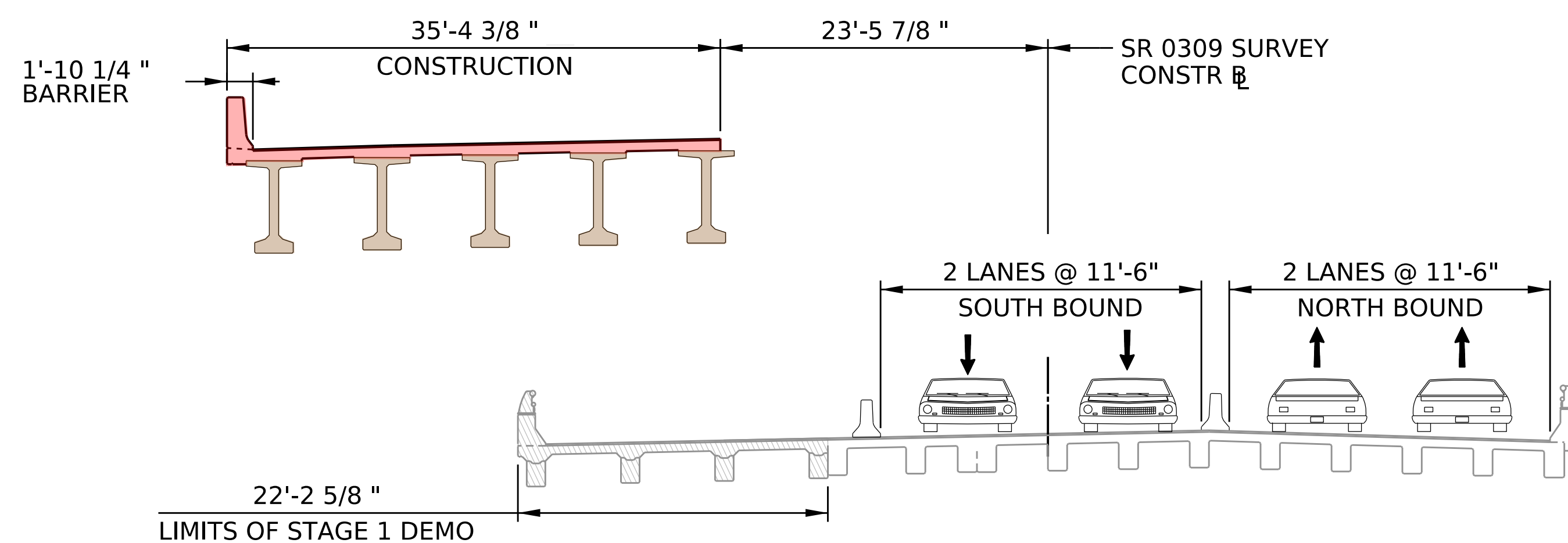
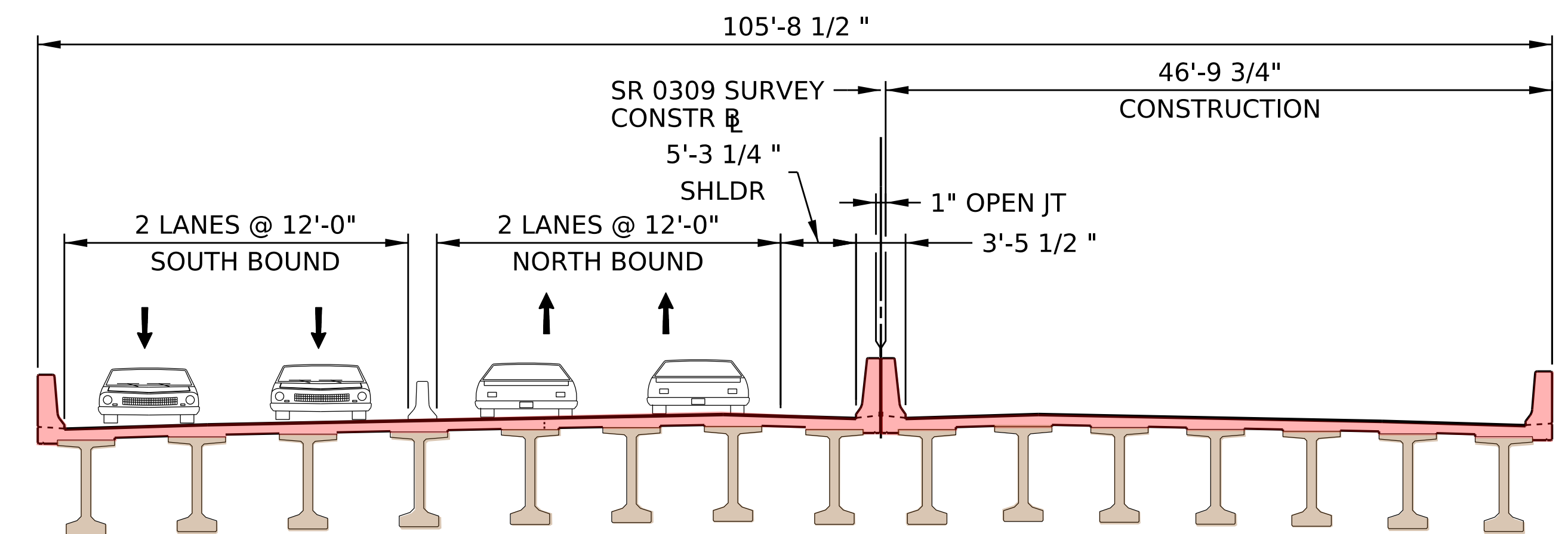
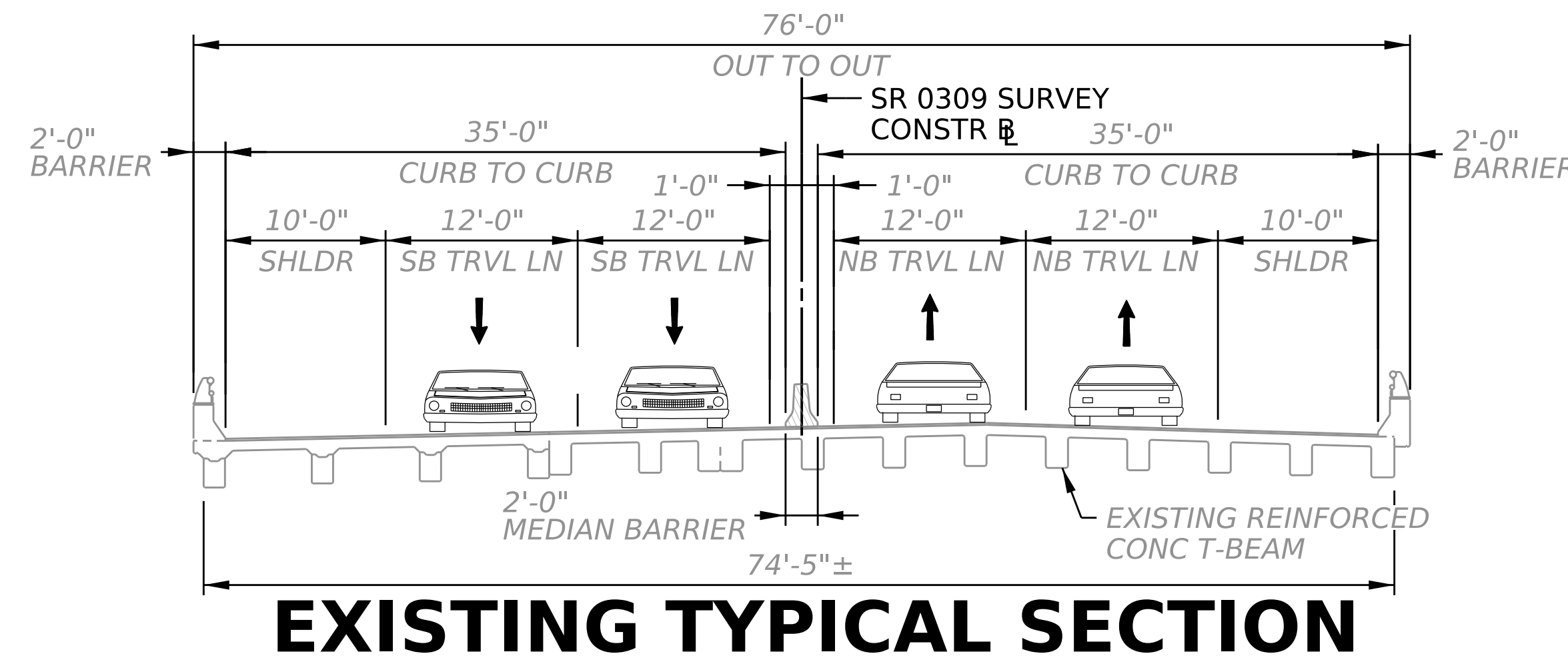

STAGE 1 NOTE:
REMOVE EXISTING MEDIAN BARRIER PRIOR TO STAGE 1.

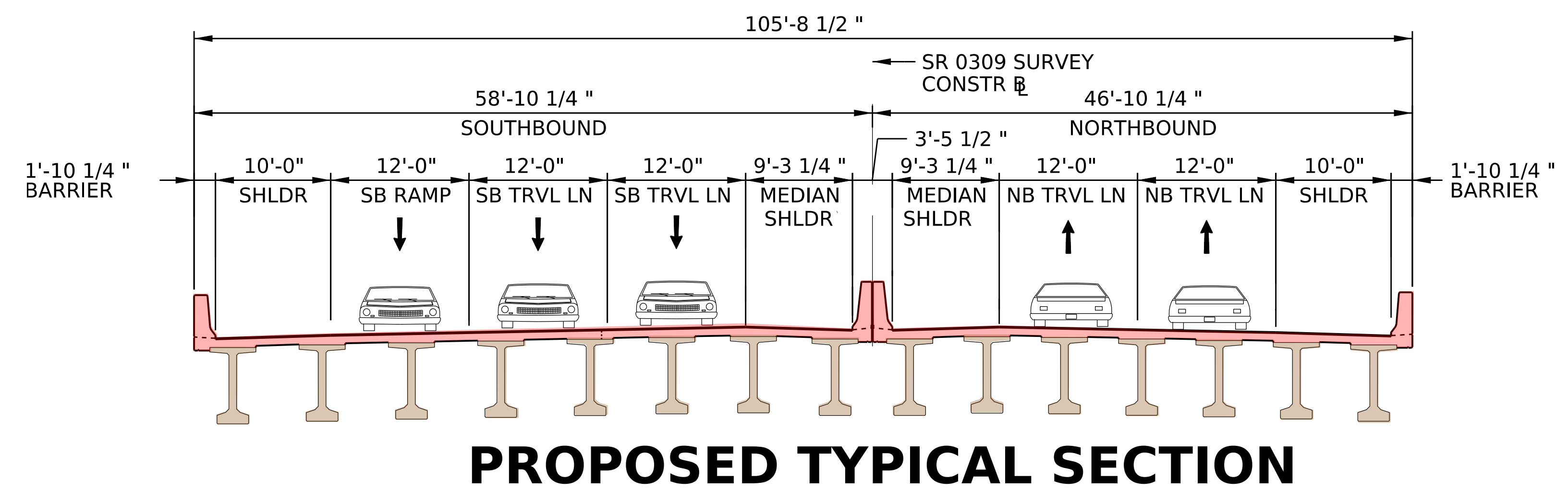
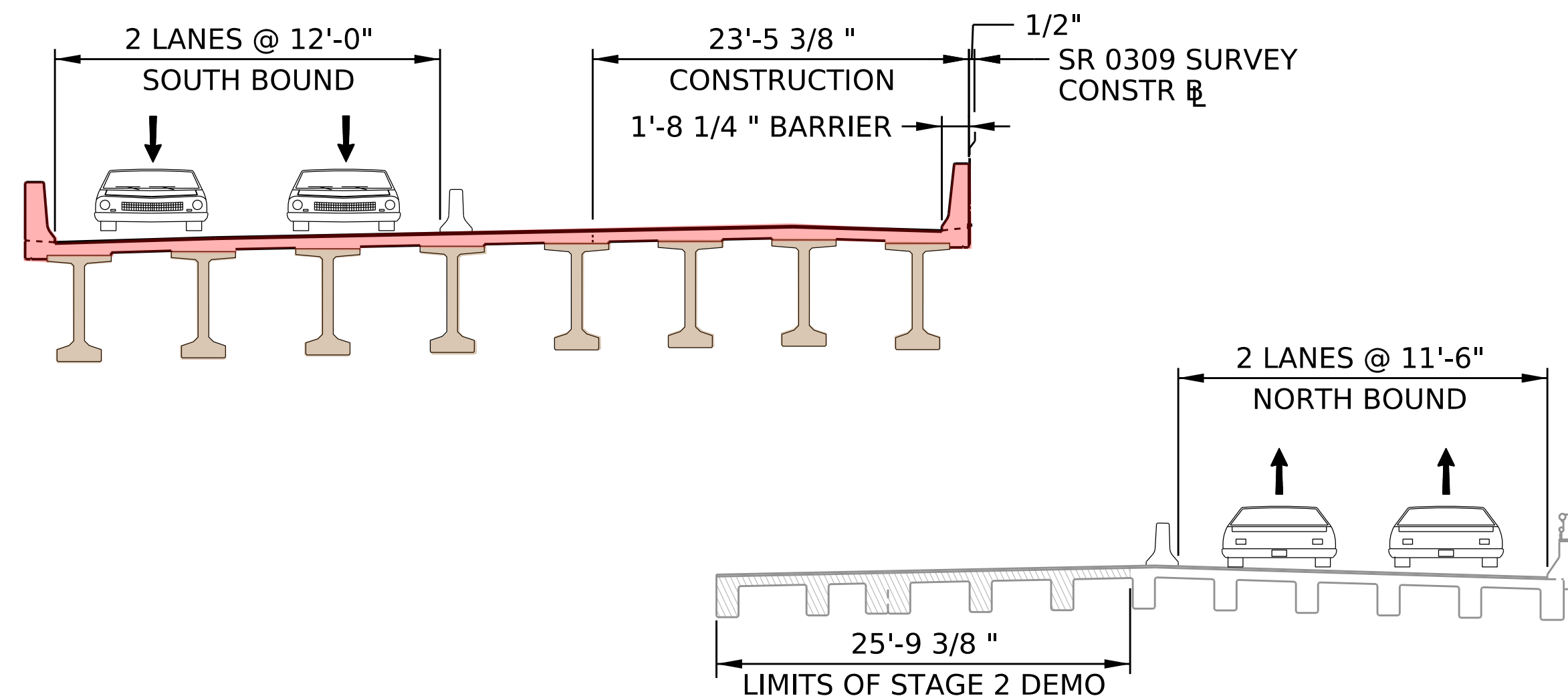

LEGEND:

- STAGE DEMOLITION
- PROPOSED DECK & BARRIER
- PROPOSED GIRDERS