

PLOTTED: 2-OCT-2024 07:37

OPERATOR: jormosher
FILE NAME: p:\p2\DEDCRAPP\WID\1.pend\cd\connect_P\Projects\00120-Crawford\20 1007 DF1 420\DESIGN\Roadway\CADD Files\201007DF1_NAME.dgn

DISTRICT	COUNTY	ROUTE	SECTION
01	CRAWFORD	1007	DF1

ROCKDALE & BLOOMFIELD TOWNSHIPS			
REV NO	REVISIONS	DATE	BY APPD

PRELIMINARY
NOT FOR CONSTRUCTION

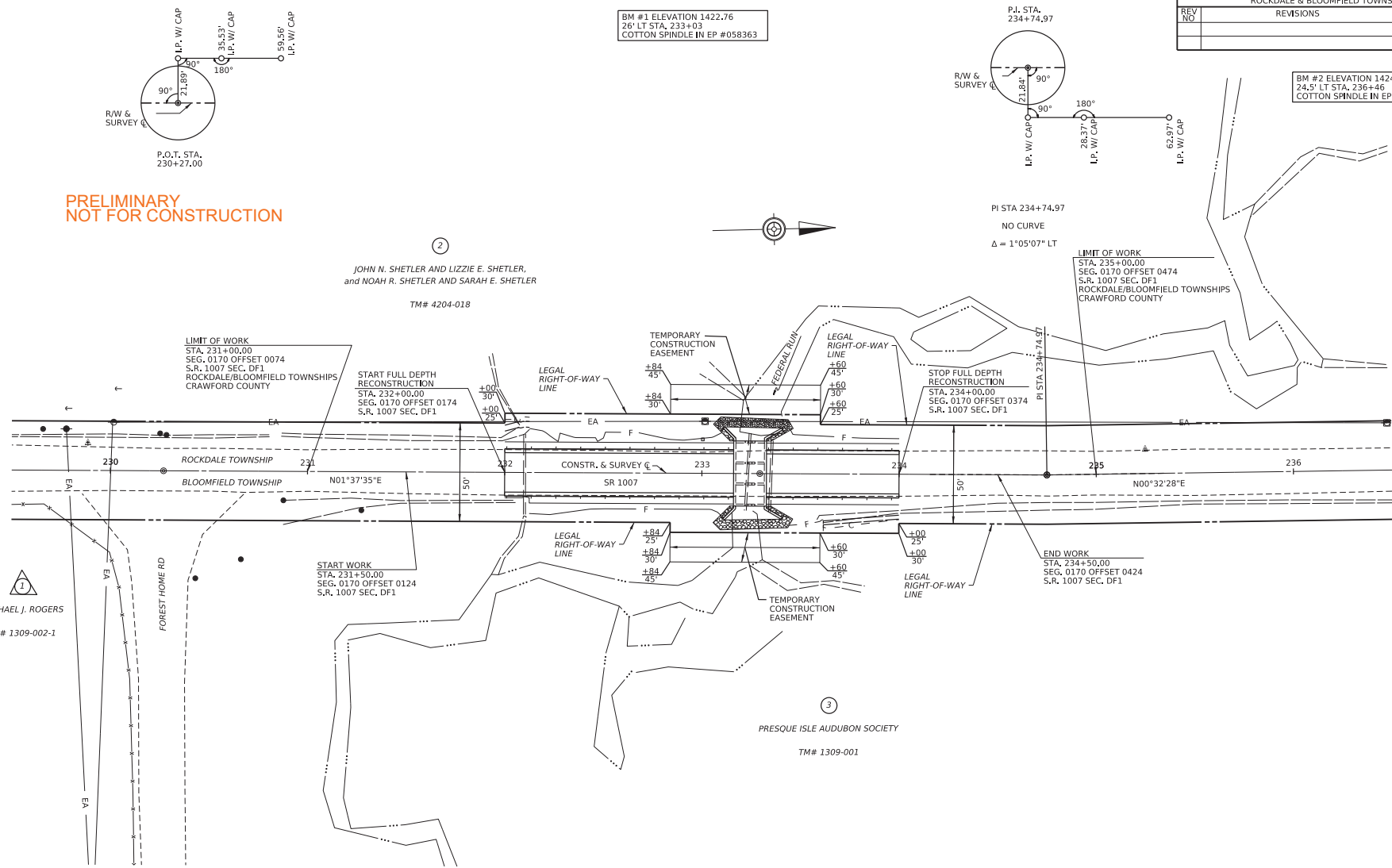

BM #1 ELEVATION 1422.76
26' LT STA, 233+03
COTTON SPINDLE IN EP #058363

BM #2 ELEVATION 1424.32
24.5' LT STA, 236+46
COTTON SPINDLE IN EP #058364

STRUCTURE DATA

EXISTING STRUCTURE	PROPOSED STRUCTURE
STATION: 233+30	STATION: 233+25.00
TYPE: ELLIPTICAL CMP	TYPE: BOX CULVERT
SPANS: 2 PIPES @ 10'0"	SPANS: 1 @ 16'0"
AVG. UNDER CLEARANCE:	AVG. UNDER CLEARANCE:
SKEW: 90°	SKEW: 90°
CLEAR ROADWAY WIDTH: 20'	CLEAR ROADWAY WIDTH: 24'
	STRUCTURE NO.
	RECOMMENDED: PENDING

SCALE



HORIZONTAL

SURVEY BOOK 20654

PLOTTED: 10-OCT-2024 07:55

OPERATOR: mdunham
FILE NAME: P:\7\DEDCR\APP\W01_penndot.ctb\Connect_Projects\Documents\OpenRoads_Projects\DD120-Crawford201007.DF1 (450)\DESIGN\Bridges\CADD_Files\1007_Mastiff.rvt.dgn

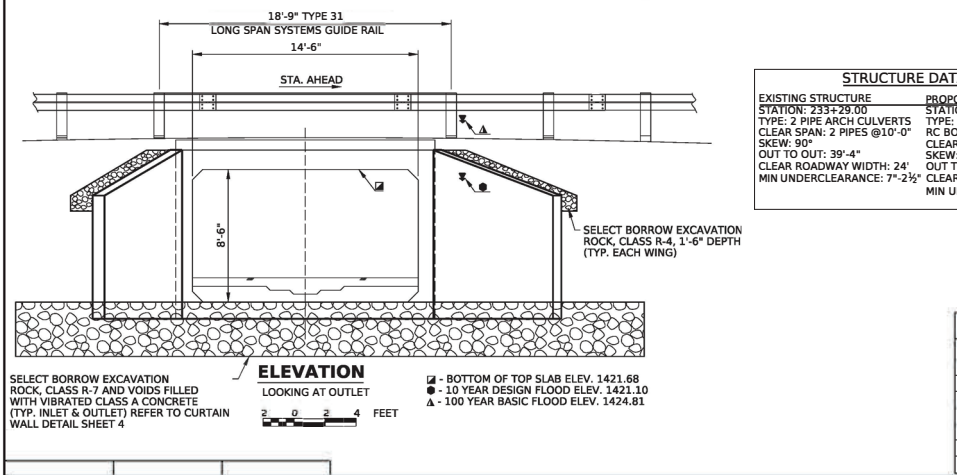
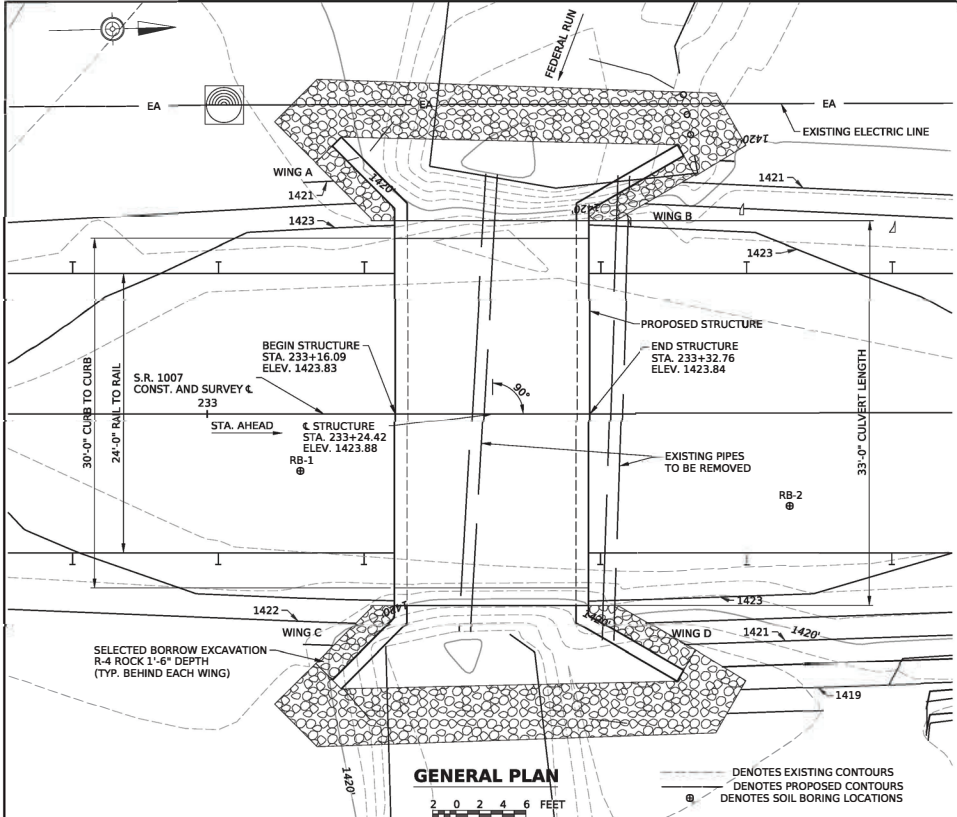

STRUCTURE DATA

EXISTING STRUCTURE	PROPOSED STRUCTURE
STATION: 233+29.00	STATION: 233+24.42
TYPE: 2 PIPE ARCH CULVERTS	TYPE: SINGLE CELL PRECAST RC BOX CULVERT
CLEAR SPAN: 2 PIPES @10'-0"	CLEAR SPAN: 1 @14'-6"
SKEW: 90°	SKEW: 90°
OUT TO OUT: 39'-4"	OUT TO OUT: 33'
CLEAR ROADWAY WIDTH: 24'	CLEAR ROADWAY WIDTH: 24'
MIN UNDERCLEARANCE: 7'-2 1/2"	MIN UNDERCLEARANCE: 6'-10 1/2"

PRELIMINARY
NOT FOR CONSTRUCTION

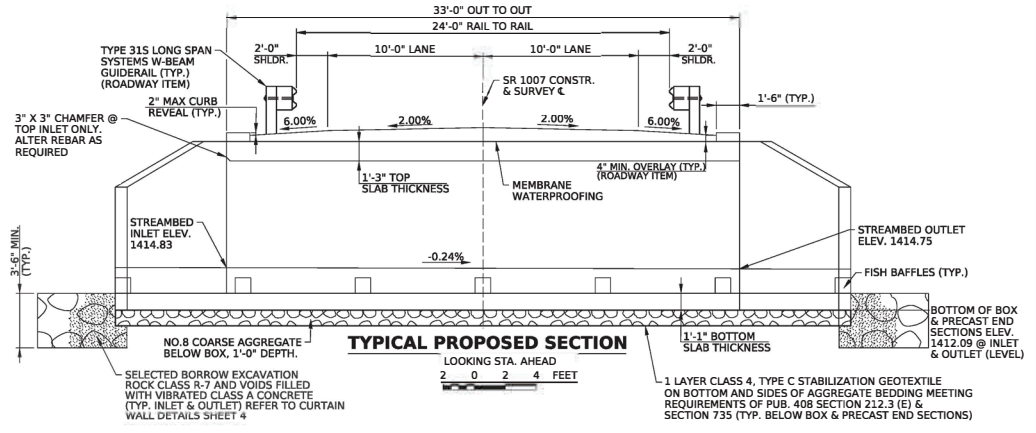

GRADE PROFILE DATA @ C STRUCTURE

PVC STA. 233+06.25 ELEV. 1423.67	PVI STA. 233+22.75 ELEV. 1424.03	STA. 233+32.76 ELEV. 1423.84	PVT STA. 233+39.25 ELEV. 1423.76
233+16.09 ELEV. 1423.83	STA. 233+24.42 ELEV. 1423.88		
VC 33 MO -0.15 SSD 305'			

HYDROLOGIC & HYDRAULIC DATA

DRAINAGE AREA = 2.36 SQ. MI.
LATITUDE: 41°48'04.73" LONGITUDE: 79°54'36.35"

FLOOD	FREQ.	Q (CFS)	ELEV.	V (FPS)
EXISTING STRUCTURE				
DESIGN	10 YR	611.00	1421.29	10.07
BASIC	100 YR	1340.00	1425.11	10.66
PROPOSED STRUCTURE				
DESIGN	10 YR	611.00	1421.10	10.71
BASIC	100 YR	1340.00	1424.81	13.32

AS-BUILT PLANS LOG

Signature _____ Date _____

AS-BUILT PLANS ARE TO BE MAINTAINED DURING CONSTRUCTION AND THIS SECTION SIGNED AT CONSTRUCTION COMPLETION FOR DOCUMENTATION.

Mark	Description	By	Chk'd	Recm'd	Date
REVISIONS					
S.R. 1007 PREVIOUSLY KNOWN AS L.R. 20081 BMS STR ID: 20100701700305 MPMS/ECMS PROJ: 420 / 97065 BRKEY: 70640					

**COMMONWEALTH OF PENNSYLVANIA
DEPARTMENT OF TRANSPORTATION**

**CRAWFORD COUNTY
S.R. 1007 SECTION DF1
SEGMENT 0170 OFFSET 0305
STA. 233+24.42
OVER FEDERAL RUN
14'-6" X 8'-6" PRECAST R.C. BOX CULVERT
GENERAL PLAN**

RECOMMENDED _____ SHEET _____ OF _____

DISTRICT BRIDGE ENGINEER
S - 42419

SUPPLEMENTAL DRAWINGS

DESCRIPTION	DWG. NO.	APP. DATE
CLASSIFICATION OF EARTHWORK FOR STRUCTURES	RC-11M	06-01-10
BACKFILL AT STRUCTURES	RC-12M	11-01-22
TYPE 31 STRONG POST GUIDE RAIL	RC-51M	09-01-23
ANCHOR SYSTEMS	BC-734M	02-19-21
REINFORCEMENT BAR FABRICATION DETAILS	BC-736M	11-23-22
TYPICAL WATERPROOFING AND EXPANSION DETAILS	BC-788M	11-23-22
MECHANICAL CONNECTION DETAILS	BC-798M	02-14-23

PREPARED BY
DISTRICT 1-0
BRIDGE UNIT

KENNETH A. SANOSKI
REGISTERED PROFESSIONAL ENGINEER
No. 0000000000
PENNSYLVANIA